

How to Enroll your Apple iPhone device

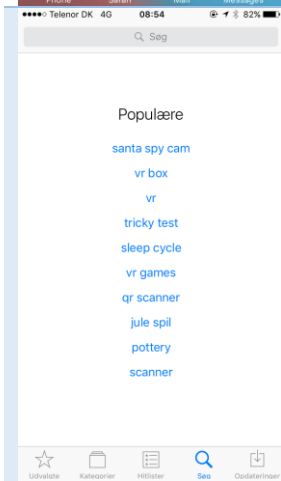

Find and open your "App Store"



Select Search

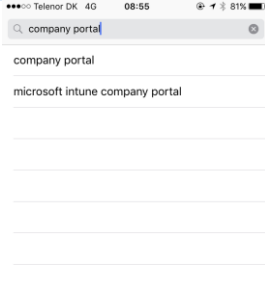

Search for: "Company Portal" and select "Microsoft intune company portal"

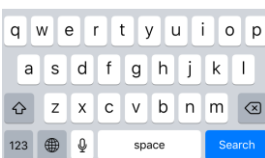

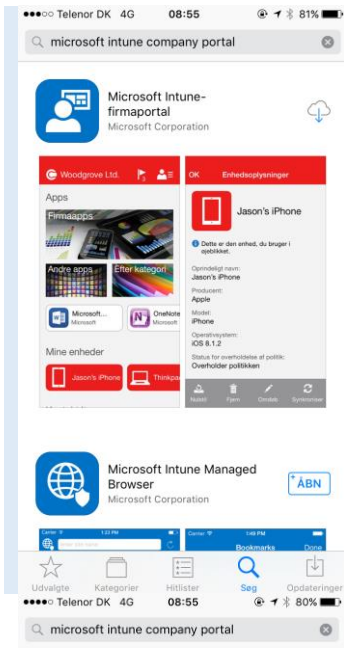

Select Get or “the download cloud” if the app has been downloaded before.

Open Microsoft Intune-Company Portal

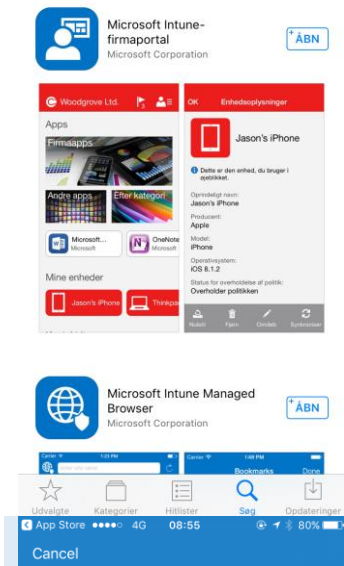

Now please type your company email address in the someone@example.com after typing – your email address the logo will change to Nederman

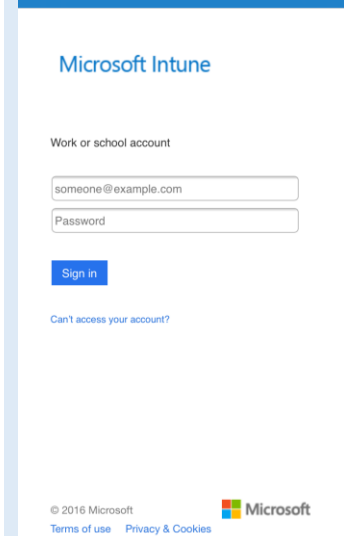



Now please type your password and “Sign in”

Nederman

Sign in with your work or school account

Sign in

Can't access your account?

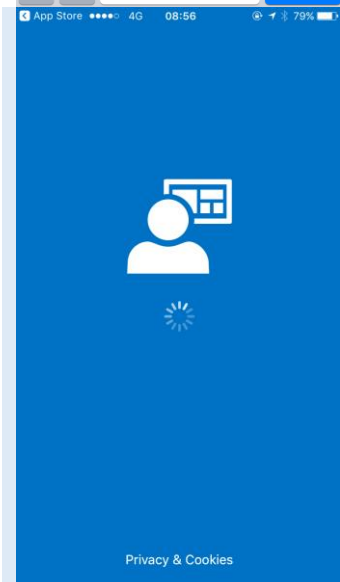
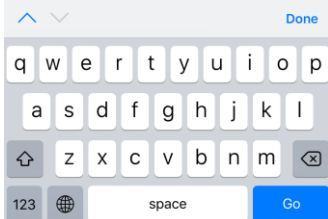

The Enrollment process is now starting – you will be prompted with different information under the process.

Nederman

Begin

Company Access Setup

We'll help you set up your device to access the Company Portal, internal apps and other company resources.

Device Enrollment

Enrollment lets your company manage your device and gives you access to company resources.

Device Compliance

You might need to set a passcode or change your email configuration.

[More information about enrolling your device](#)

[Skip Setup](#)

Press “Begin” in the upper right corner to start the first step of enrollment

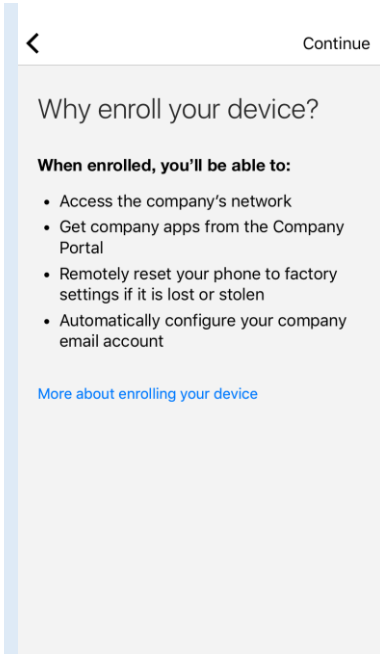

Push "Continue" in the upper right corner.

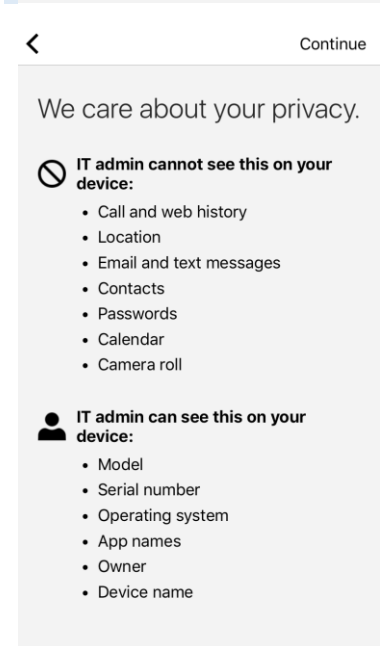

Push "Continue" in the upper right corner.

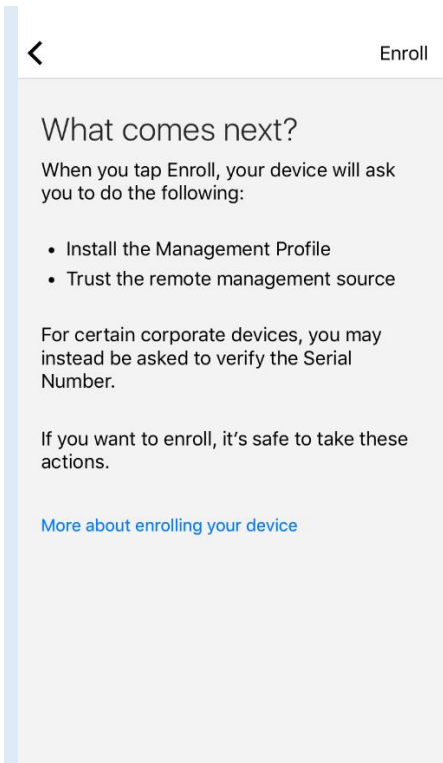

Push "Enroll" in the upper right corner to start – the enrollment process of the Apple Device.

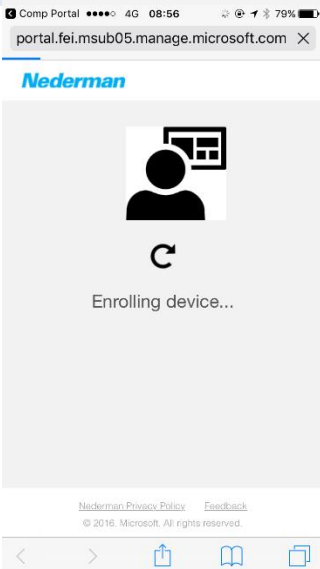

Please wait while the information is downloaded to the device.

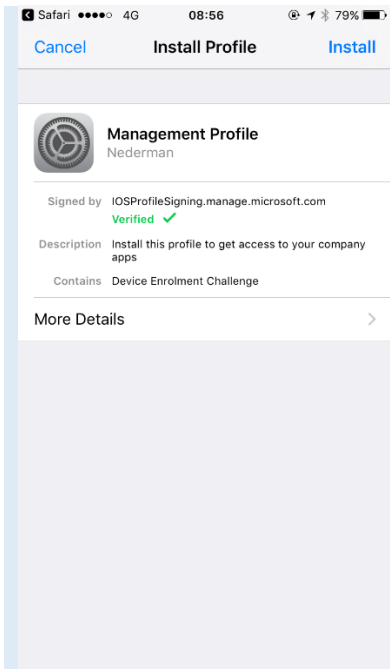

Push "Install" in the upper right corner to continue.

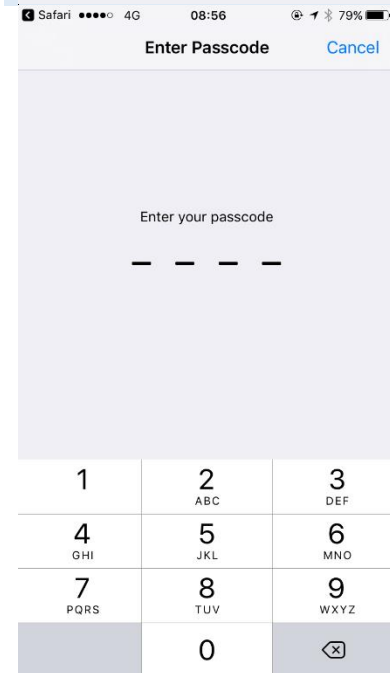

Enter your pin-code for the device.

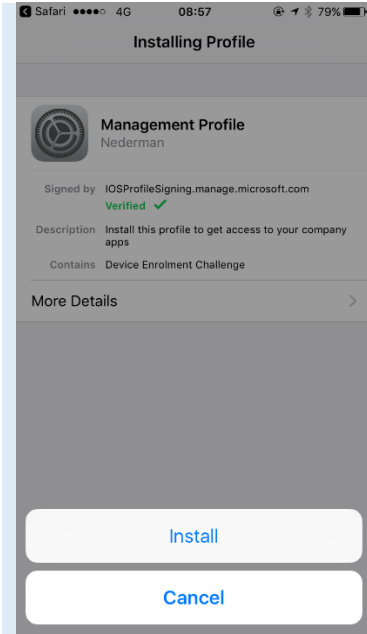

Push "Install".

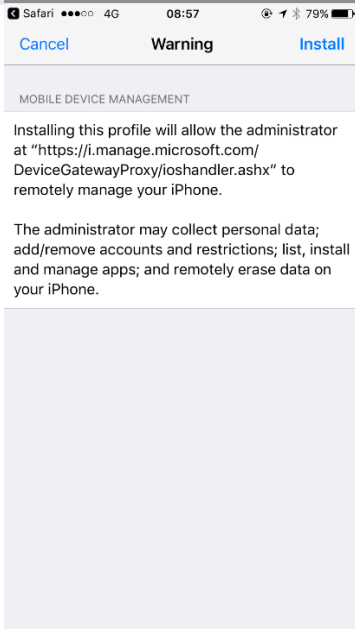

Push "Install" in the upper right corner, to continue the administrator mentioned is Nederman.

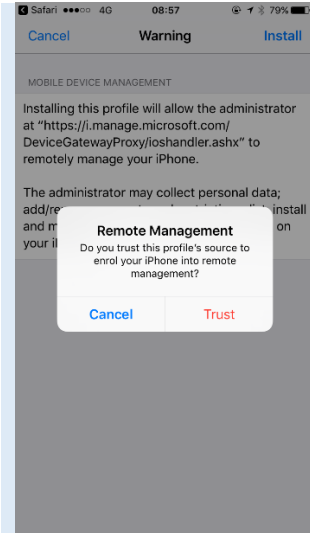

Push "Trust".

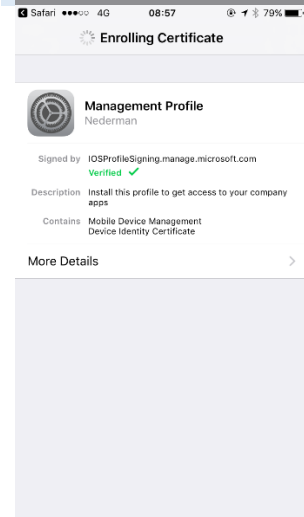

The Management Profile will now install security certificates

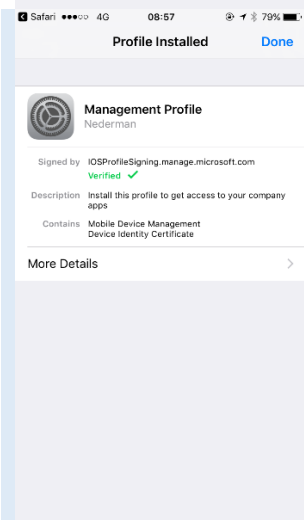

When the management profile is done installing please push "Done".

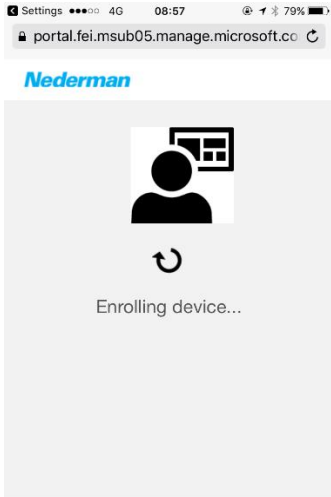

Please wait for the enrollment of the device to complete.

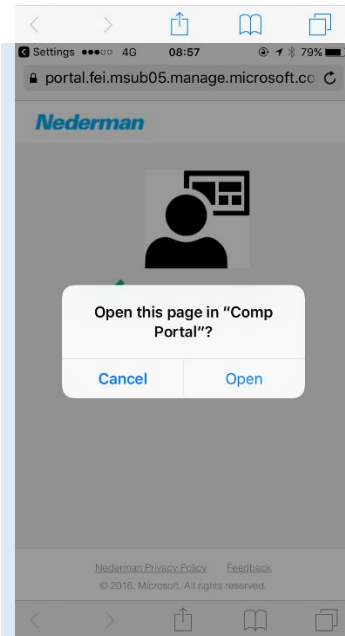

Push "Open" to return to Microsoft Intune Company Portal – and continue the compliance part of the enrollment.

Continue

Company Access Setup

We'll help you set up your device to access the Company Portal, internal apps and other company resources.

Device Enrollment

Enrollment lets your company manage your device and gives you access to company resources.

Device Compliance

You might need to set a passcode or change your email configuration.

[More information about enrolling your device](#)

Skip Setup



Checking compliance...

This may take a few minutes... Feel free to do something else and check back later.

Check Compliance

Push "Continue" in the upper right corner to Compliance check the device.

The Compliance check is now running, this process can take a few minutes – if some settings on the phone doesn't meet the compliance level, you will be asked to change this and compliance check again.

Company Access Setup

We'll help you set up your device to access the Company Portal, internal apps and other company resources.

Device Enrollment

Enrollment lets your company manage your device and gives you access to company resources.

Device Compliance

You might need to set a passcode or change your email configuration.

[More information about enrolling your device](#)

Congratulation your device is now approved – please push “Continue”

Company Access Setup Complete

Your device is now ready to access the Company Portal, internal apps and other company resources.

If you have difficulty accessing company resources, contact your IT administrator for assistance.

Push “Done” in the upper right corner to return to the Microsoft Intune Company portal.

Now your Device will start to receive Wi-Fi profile settings, email settings, security settings and access to Company Application from Company Portal.

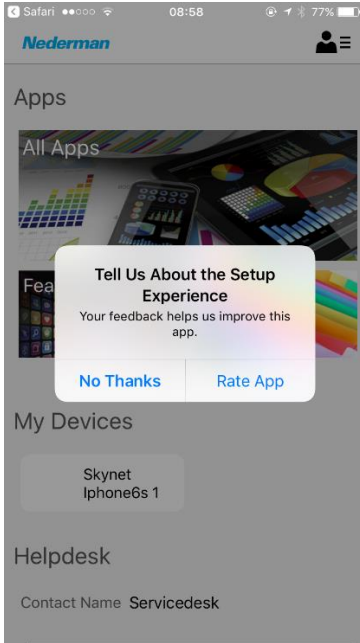

When returning to the Company Portal you can rate the application push “No Thanks”.